



Armored
Optical Fiber Cables

Distribution Bundle
Simplex | Duplex

Jelly-Filled
Patch cord

Access Technologies ... FTTX, IP Digital Surveillance Networking



Features (Distribution Bundle):

- The AOFC is suitable for linking the facilities inside the home and the outside cable plant for Fiber To The Home (FTTH) applications. The tight buffer fibers can be single mode fiber (SMF) or multimode fiber (MMF). The major operating wavelengths for SMF are 1310nm and 1550nm for cable routing. The 850nm and 1300nm are the major operating wavelengths for MMF in the cable routing.
- The geometric and the optical characteristics of the optical fibers all follow the latest definitions of ITU-T.G652, ANSI/TIA/EIA-492AAAA and ISO11801. All the terminologies and testing methods also follow the above Recommendations.
- The AOFC can be installed at -30 to 60 °C and normally operated and stored at -40 to 85 °C . Also provides stable, low loss and reliable transmitting characteristics.
- All the outer sheaths of AOFCables are flame retardant (FR) or low smoke zero halogen (LSZH) thermal plastic compounds and meet the safety requirements for the environment concerning.
- The stainless steel armoring provides a rugged structure to against attacking from rodent, termite, and bullet. The rugged protection design enable the AOFCables be directly buried for outdoor connecting and routing.

Distribution AOFCables

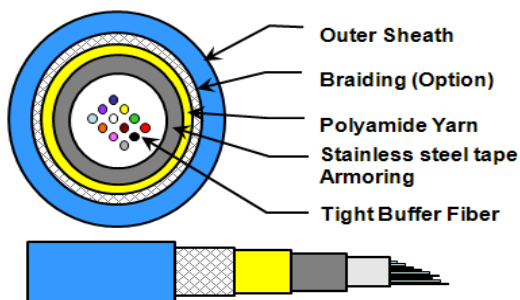

Applications:

- The Distribution AOFCable is designed for indoor trunk line interconnecting
- This type of cable can be directly assembled with connectors as pigtail or patch cord for cross connect applications
- Each single Tight Buffer Fiber can be the Distributed branch for multiple points access or routing

Shipping Package:

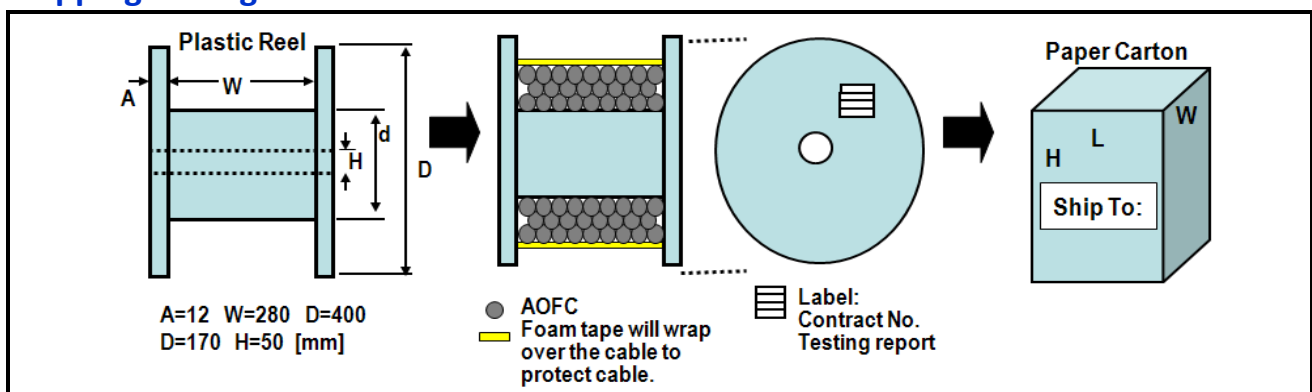



Armored
Optical Fiber Cables

Distribution Bundle
Simplex Duplex

Jelly-Filled
Patch cord

Access Technologies ... FTTX, IP Digital Surveillance Networking



Characteristics:

Fiber type		SMF 9/125	MMF 50/125	MMF 62.5/125
Cable Char.				
Number of Fiber		1 fiber		
Cable Outer Diameter		2.9 mm / 0.11 inches		
Cable Weight		18 kg/km / 40 lb/kft		
Factory Length		500m (+10m, -0m) per reel		
Min. Bending Radius		24mm @ loaded / 44mm @ installed		
Max. Tensile Load		200N @ long term / 400N @ short term		
Crush Resistance		3,000N/100mm ² @ long term / 5,000N/100mm ² @ short term		
Optical Attenuation		< 0.35 dB/km @ 1310nm	< 3.5 dB/km @ 850nm	
		< 0.25 dB/km @ 1550nm	< 1.0 dB/km @ 1300nm	
Attenuation Uniformity		< 0.15dB @1550±25nm	< 0.25dB @ 850/1300±20nm	
Zero Dispersion λ_0		1300~1324nm	--	
S_0 at λ_0		$\leq 0.093\text{ps/km-nm}^2$	--	
$\lambda_{\text{cutoff}} - \text{Cable}$		$\leq 1280\text{nm}$	--	
MFD		8.5~9.5 $\mu\text{m} \pm 5\%$ @ 1310nm	--	
Modal Bandwidth	@ 850nm±20nm		$\geq 500\text{MHz}$	$\geq 200\text{MHz-km}$
	@ 1310nm±20nm		$\geq 500\text{MHz}$	$\geq 500\text{MHz-km}$
Fiber Splice Loss		< 0.2dB / average < 0.15dB		

Order Information:

Fiber Count	Fiber Type	Cable Type	Braiding	Sheath Materials	Sheath Color	Length (m)
□□C	-□□	-BD	-□□	-□	□	-□□□□
04~12	S1: Regular 10/125 SMF; M5: 50/125 μm MMF M6: 62.5/125 μm MMF; SS: Specified SMF; SM: Specified MMF Note: Customer specified fiber, please note the detail when placing order	BD: Distribution;	XX : No braiding; 1M : Metal wire braiding; 1Y : Yarn braiding;	4: Flame Retardant LSZH thermoplastic compound; 6: Other, customer specify____	1: Blue; 2: Yellow; 3: Green; 4: Red; 5: Violet; 6: White; 7: Brown; 8: Black; A: Aqua; O: Orange; P: Pink; G: Gray	0001 : 1 meter 0002: 2 meters 0003: 3 meters 、 、 、 0999: 999 meters 1000: 1km. ** standard package is 500 meters per reel; max length is 1km/reel.